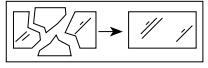

## Halbury PIR IP44 Rated Wall Light INSTRUCTION MANUAL

### Safety Warnings

- This product is suitable for outdoor use and connection to 240V~50Hz supply.
- If you are in any doubt about your competence please consult a qualified electrician.
- If any modification is made it will invalidate the warranty and may render the product unsafe.
- It is recommended that this light be installed by a qualified electrician in accordance with current IEE Wiring Regulations and Building Regulations (Part P).
- Before installing your light fitting always switch off the mains supply and remove the appropriate fuse or switch off the appropriate circuit breaker before commencing installation.
- Run supply wire from a 5-amp electrical supply protected by an RCD using double insulated 2 or 3-core cable of type H05RN-F 1.0mm<sup>2</sup> (not supplied) to selected site, ensuring it is adequately protected through the full length of the cable run, it must come out of the flat surface of the wall or steps in line with the entry to the fitting.
- Except where installed in a conduit or duct which provides equivalent protection against mechanical damage, a cable buried in the ground shall incorporate an earthed armour or metal sheath or both, suitable for use as a protective conductor, or be of insulated concentric construction. Buried cables shall be marked by cable covers or a suitable marking tape. Buried conduits and ducts shall be suitably identified. Buried cables, conduits and ducts shall be at a sufficient depth to avoid being damaged by any reasonably foreseeable disturbance of the ground.
- This product contains delicate parts - be careful during handling and maintenance to avoid breakage.
- This fitting is Class II, Double Insulated  The Fitting does not require an Earth, and Live or Neutral **must not** be connected to Earth. The terminal blocks are supplied according to requirements of the fitting.
- Never fit bulbs of a higher wattage than those specified on the label (as these may cause overheating and damage the fitting).
- If the glass or diffuser is broken or cracked it must be replaced, please consult your retailer. 

### Care Information

Allow 10 minutes to cool before replacing, adjusting or cleaning.  
Clean with a dry cloth only. Do not use liquid or abrasive cleaners on this product.

### Assembly/ User Instructions

#### Before you start

Please read these instructions carefully before fitting and retain for reference. Check the packaging and make sure that you have all the required parts. Follow each assembly step in order to prevent incorrect assembly. Ensure that the product is fully assembled as illustrated before use.

#### The Light pack contains:

Light fitting.  
Terminal connection block(s).  
Fixing pack.

#### The following tools may be required:

Selection of cross and flat head screwdrivers.  
Electric drill and assorted drill bits.  
Wire strippers.  
Electrical insulation tape.

**These assembly diagrams are intended as a guide – if in doubt consult a qualified electrician.**

1. Decide on the position of the light fitting, or remove existing light fitting. Take a note of the position of the electrical connections. Ensure there is a solid mounting surface, for example a brick wall, to support the weight of the light fitting.
2. Remove the shade from the backplate (1), retaining the screws for re-use, and use as a template to mark the screw holes ensuring the bracket is horizontal. Make the holes, and secure the backplate with appropriate fittings (2).
3. Remove the diffuser box (3) and fit the bulb (4). **NOTE: Never fit bulbs of a higher wattage than those specified on the label (as these may cause overheating and damage the fitting).** If the diffuser becomes damaged or broken, it must be replaced.



4. Remove the terminal box and connect the house wiring to the terminal block (5). When you are sure of the connections wrap the Terminal Block and overlap the wiring both sides with 2 layers of insulation tape. **NOTE: This is a Class II fitting and must NOT be earthed.** Replace the terminal box (6), ensuring a good seal.
5. Replace the shade over the backplate (7), ensuring a good seal, and secure in place.
6. Turn on the power and test.

The PIR sensor settings can be altered by turning the dials under the fitting marked 'LUX' and 'TIME'.

## Diagram A

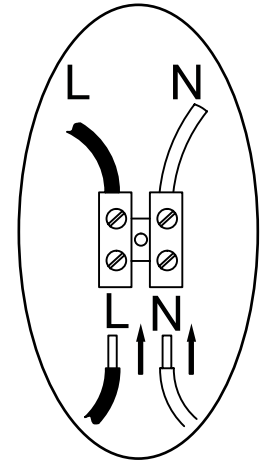
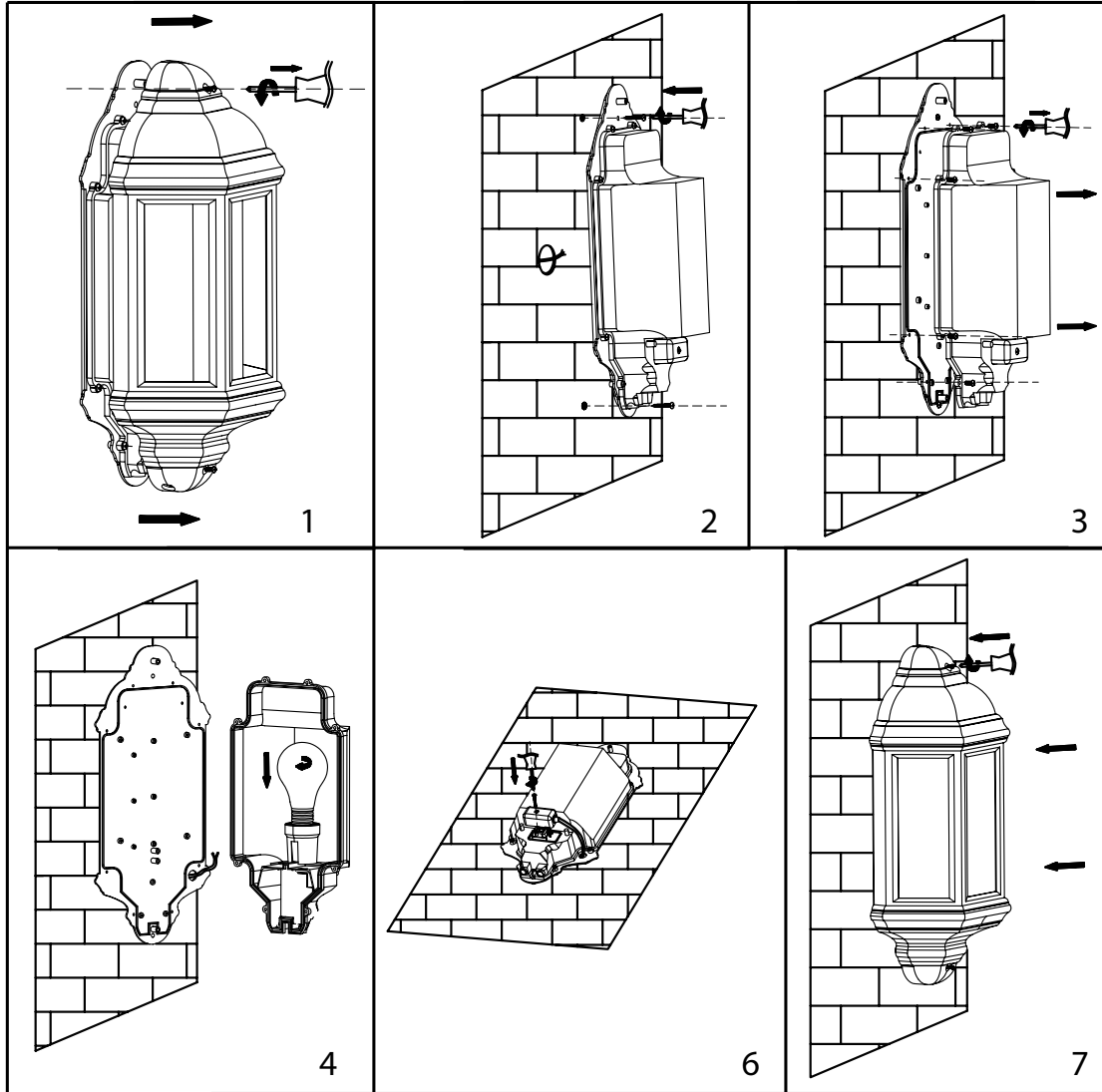

5. Wiring Diagram

## Adjusting the PIR Sensor

### Point 8

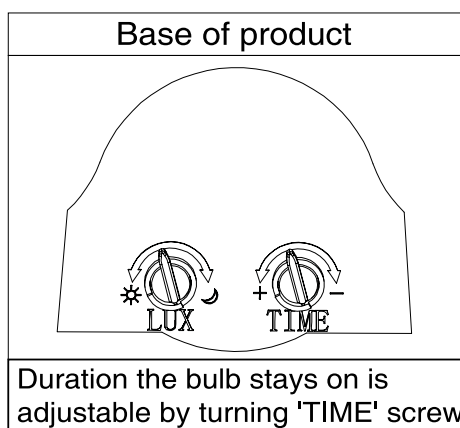

The unit must be installed in a vertical position, and fitted 1.8m - 2.5m above the ground.

The PIR sensor can be adjusted using the LUX and TIME dials.

The detection angle is set at 130 degrees, and the detection distance is set to 8m.

The PIR will start activating when the light level drops to 20 LUX and will continue to activate until the light level rises to 2000 LUX. When adjusting the sensitivity in daylight it will be necessary to cover the sensor to simulate night time.

The length of time that the light is on can be adjusted by turning the 'Time' dial, which can be altered between 5 seconds to 5 minutes duration.