

# INSTALLATION MANUAL

69050

**ecoinground**



230V | AC LED | 20W | IP67 | Stainless steel 316  
Removable honeycomb.

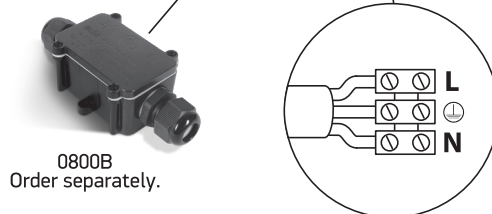
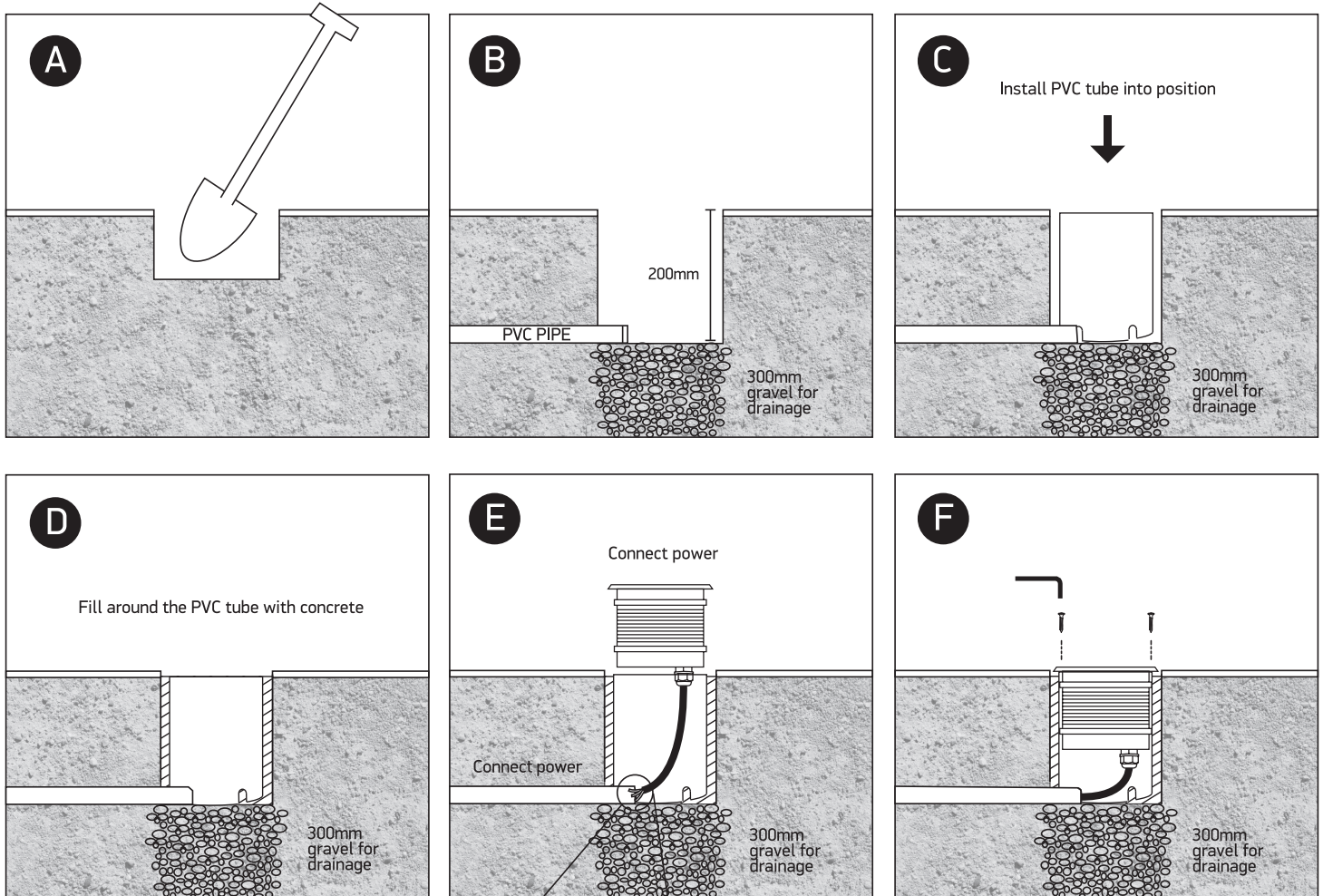
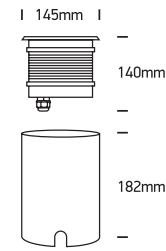

## Warnings:

1. Make sure that the product is installed properly before connecting to electricity.
2. Do not cover the fitting.
3. Maintenance and installation should only be carried out by a professional electrician.