

# INSTALLATION MANUAL

67384

**ecolight**



CE

RoHS

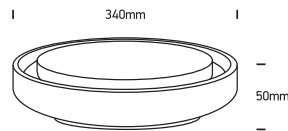

100-240V | SMD 3014 | 30W | IP54 | Die cast  
Complete with 700mA driver.

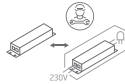

80  
CRI

**one**  
LIGHT

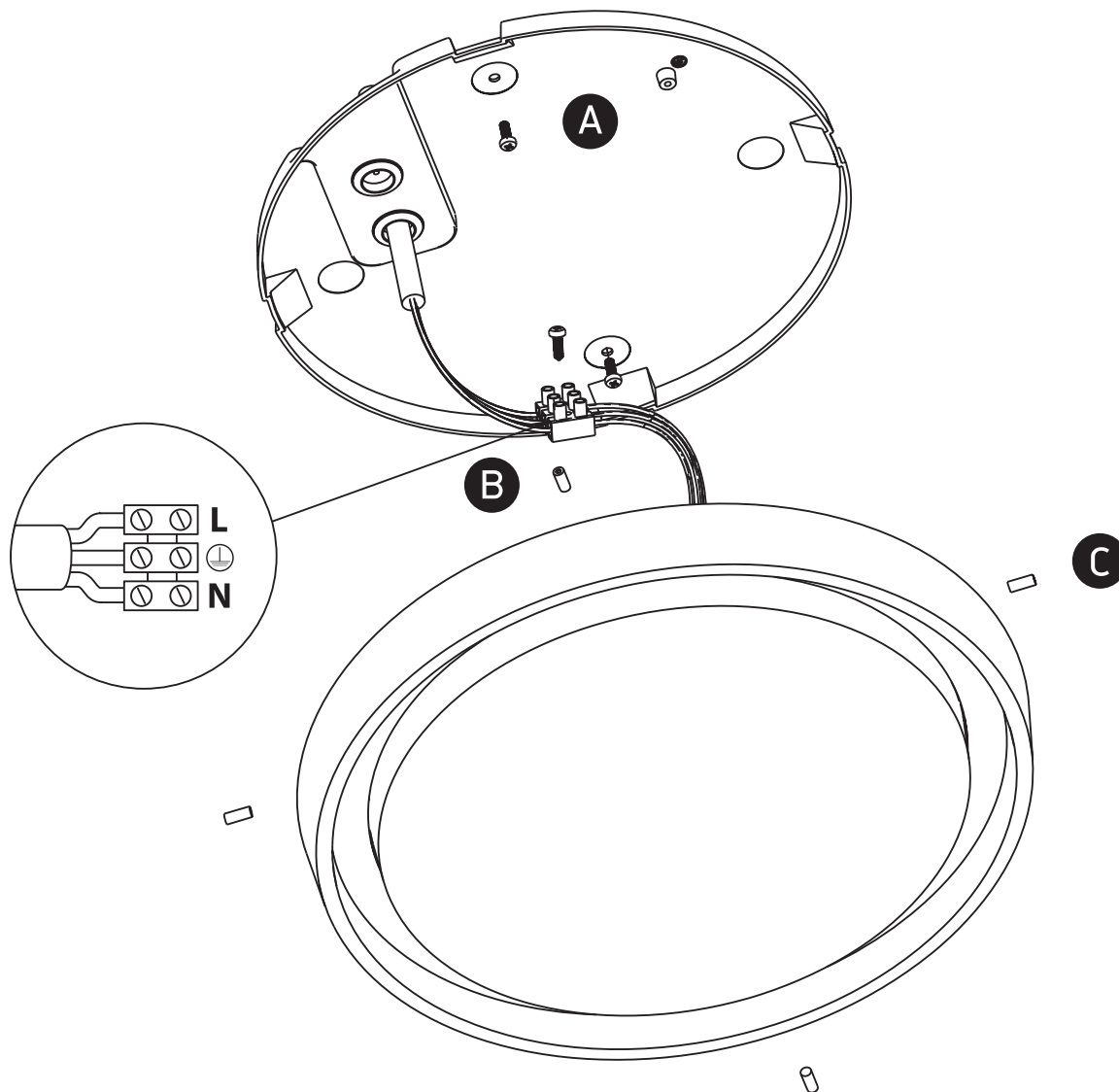

## Warnings:

1. Make sure that the product is installed properly before connecting to electricity.
2. Do not cover the fitting.
3. Maintenance and installation should only be carried out by a professional electrician.