

INSTALLATION MANUAL

67198G



100-240V | 35W | MR16 | GU10 | IP65 | Aluminium | Adjustable

Supplied with spike

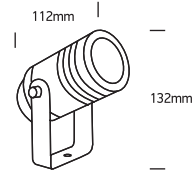

one
LIGHT

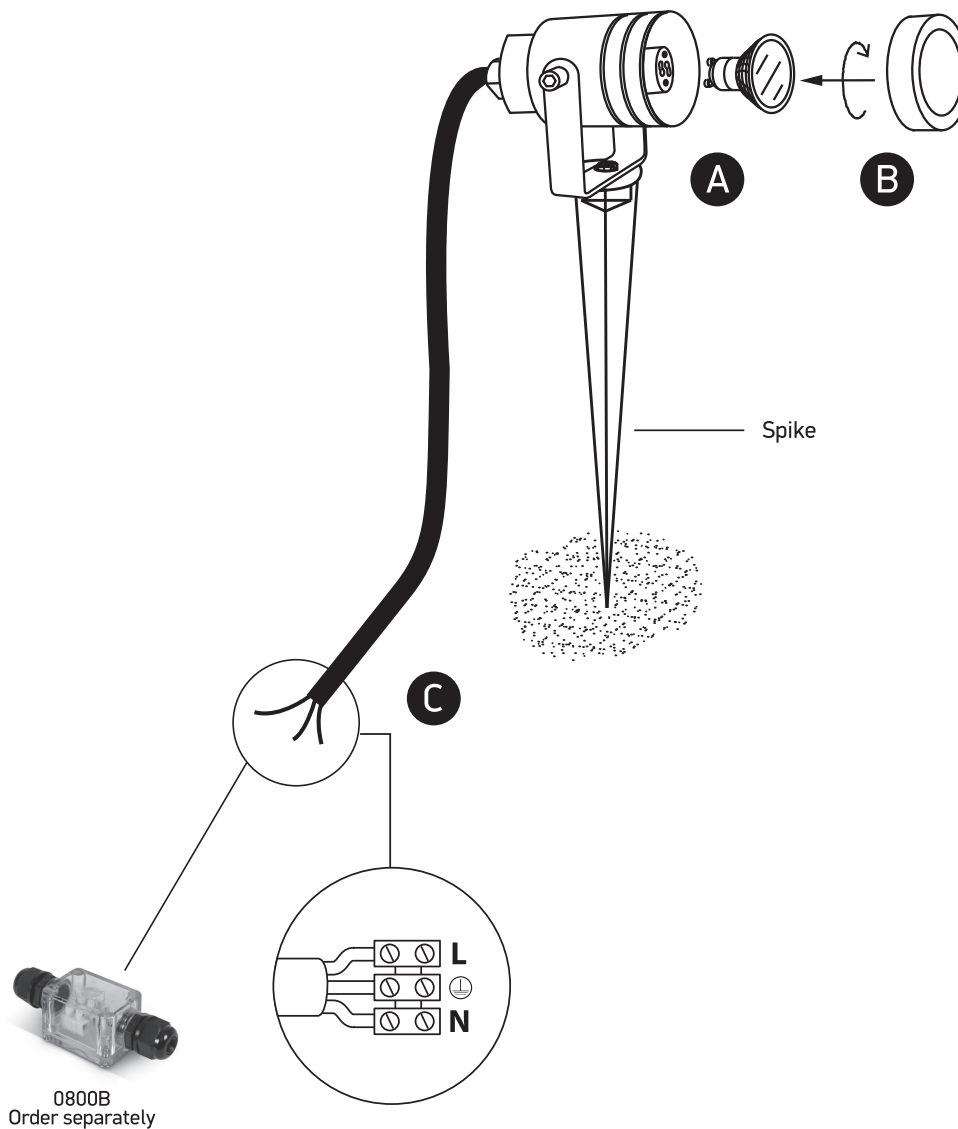

Warnings:

1. Make sure that the product is installed properly before connecting to electricity.
2. Do not cover the fitting.
3. Maintenance and installation should only be carried out by a professional electrician.