

# INSTALLATION MANUAL

62162B

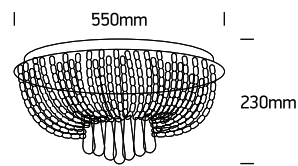

100-240V | G9 | 10 x 9W | IP20 | Metal + plastic beads + glass



**one**  
LIGHT

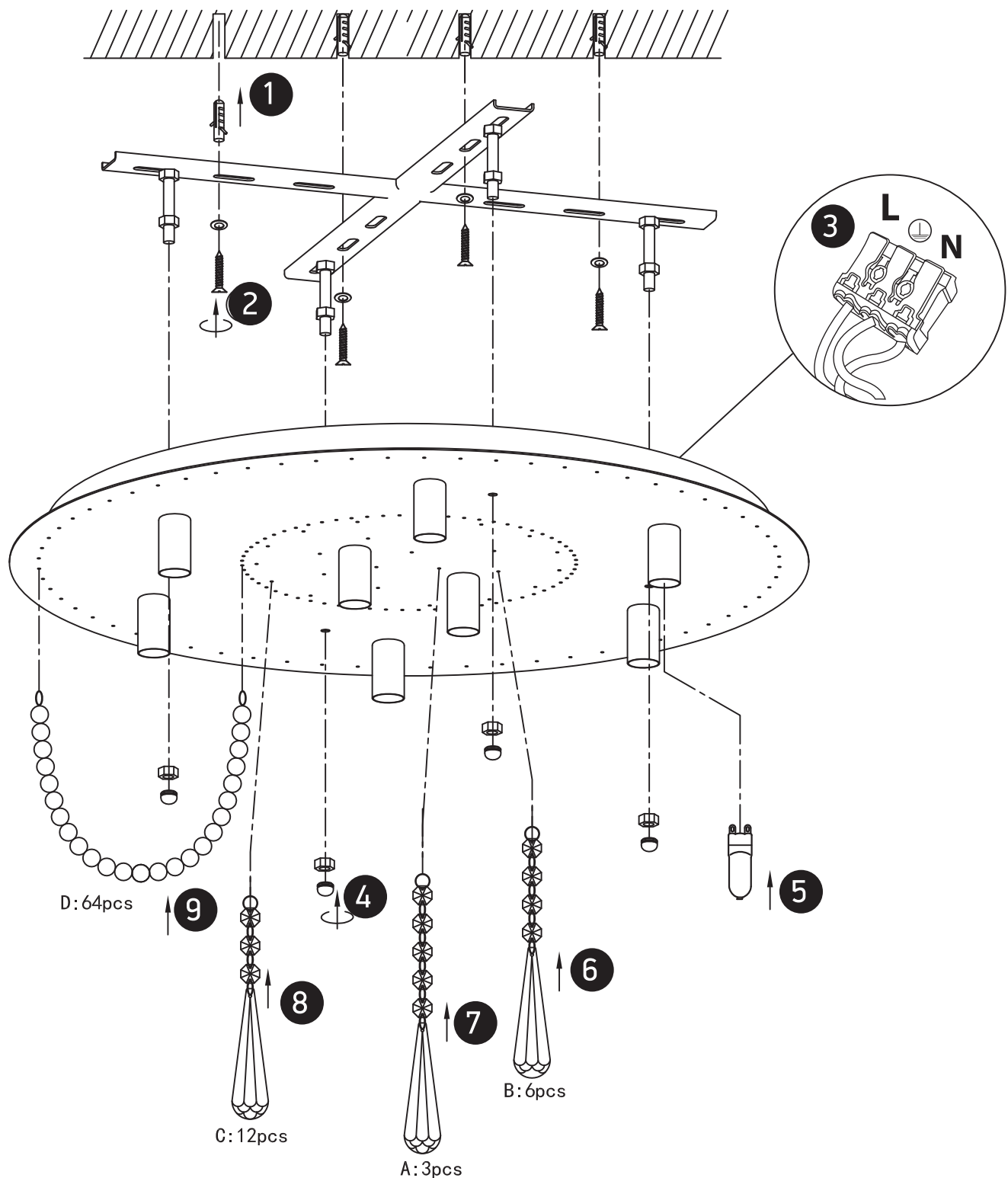

## Warnings:

1. Make sure that the product is installed properly before connecting to electricity.
2. Do not cover the fitting.
3. Maintenance and installation should only be carried out by a professional electrician.