

# INSTALLATION MANUAL

62022B

**ecolight**

**80  
CRI**
**CE**
**RoHS  
COMPLIANT**

**NOT  
DIMMABLE**

230V | SMD 2835 | 25W | IP20 | PC

Complete with driver.

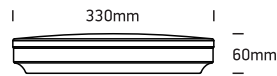
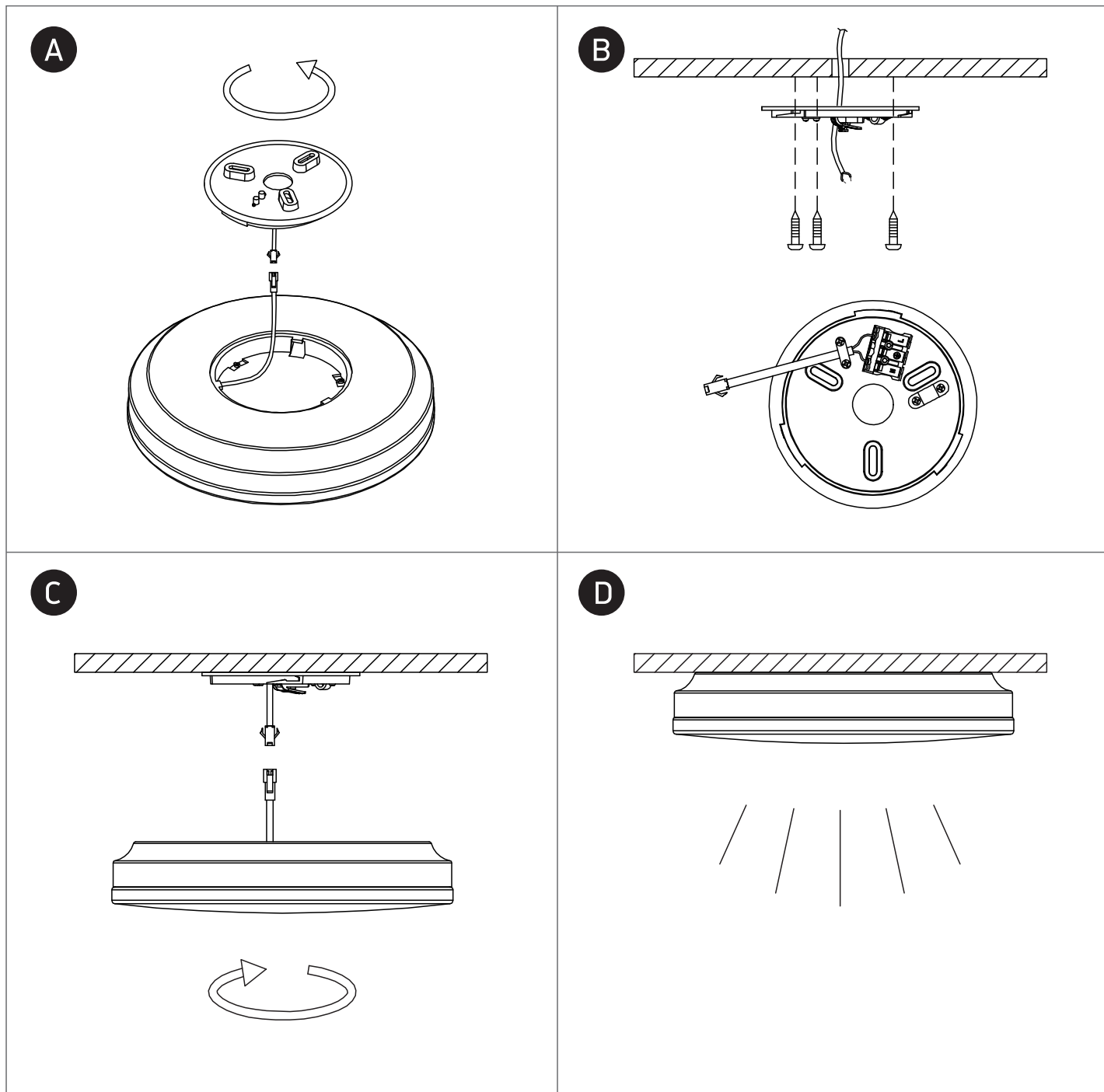
**one**  
LIGHT

## Warnings:

1. Make sure that the product is installed properly before connecting to electricity.
2. Do not cover the fitting.
3. Maintenance and installation should only be carried out by a professional electrician.