

# INSTALLATION MANUAL

62022A

**ecolight**



80  
CRI

CE

RoHS  
COMPLIANT



NOT  
DIMMABLE

230V | SMD 2835 | 20W | IP20 | PC

Complete with driver.



**one**  
LIGHT

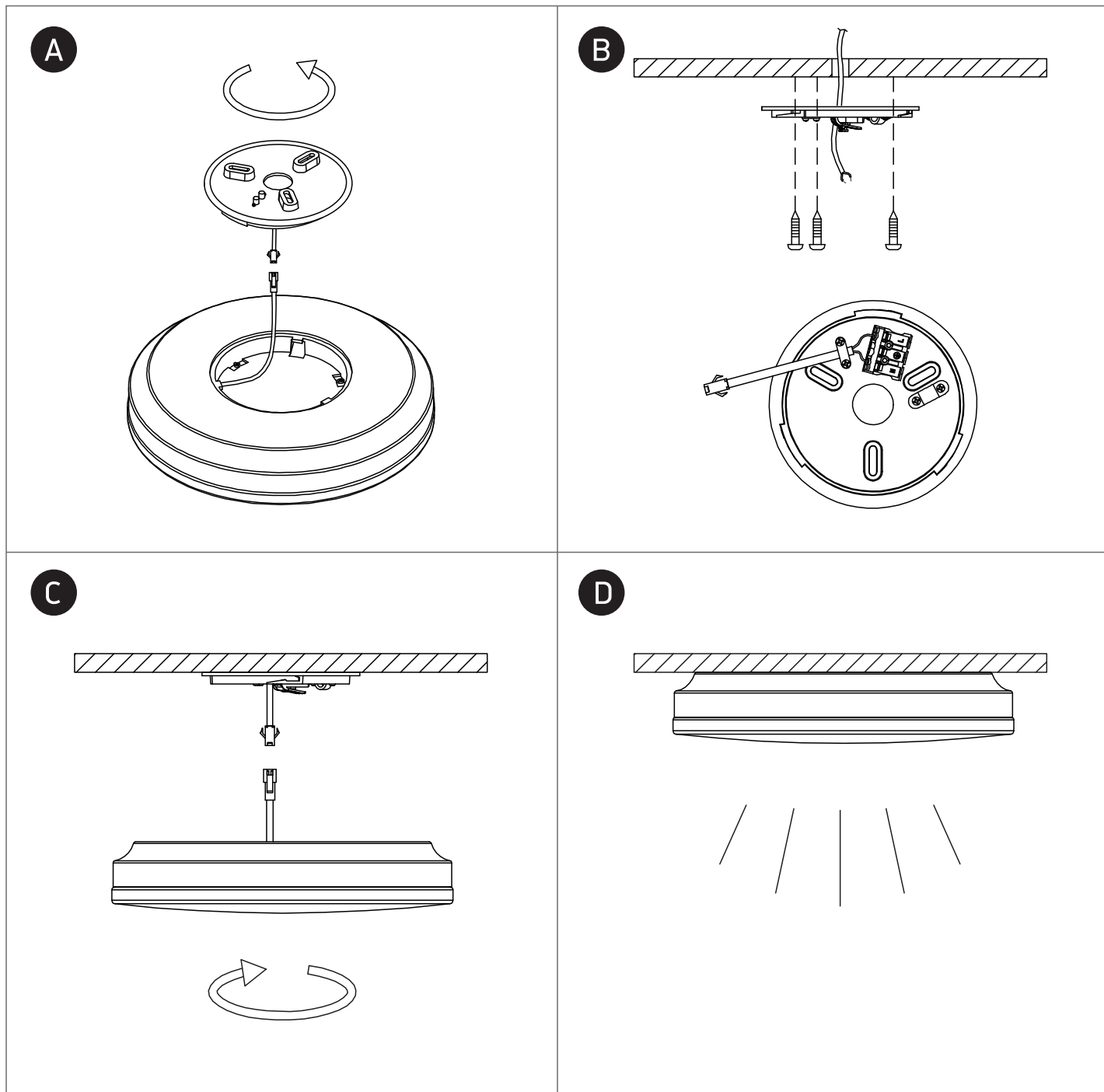

## Warnings:

1. Make sure that the product is installed properly before connecting to electricity.
2. Do not cover the fitting.
3. Maintenance and installation should only be carried out by a professional electrician.