

INSTALLATION MANUAL

61074

ecolight

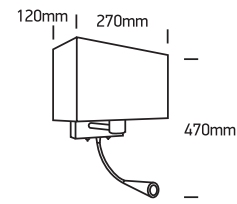

3W LED + 40W E27 | 100-240V | IP20 | Metal + white fabric shade | Adjustable

With 2 ON/OFF Switches.

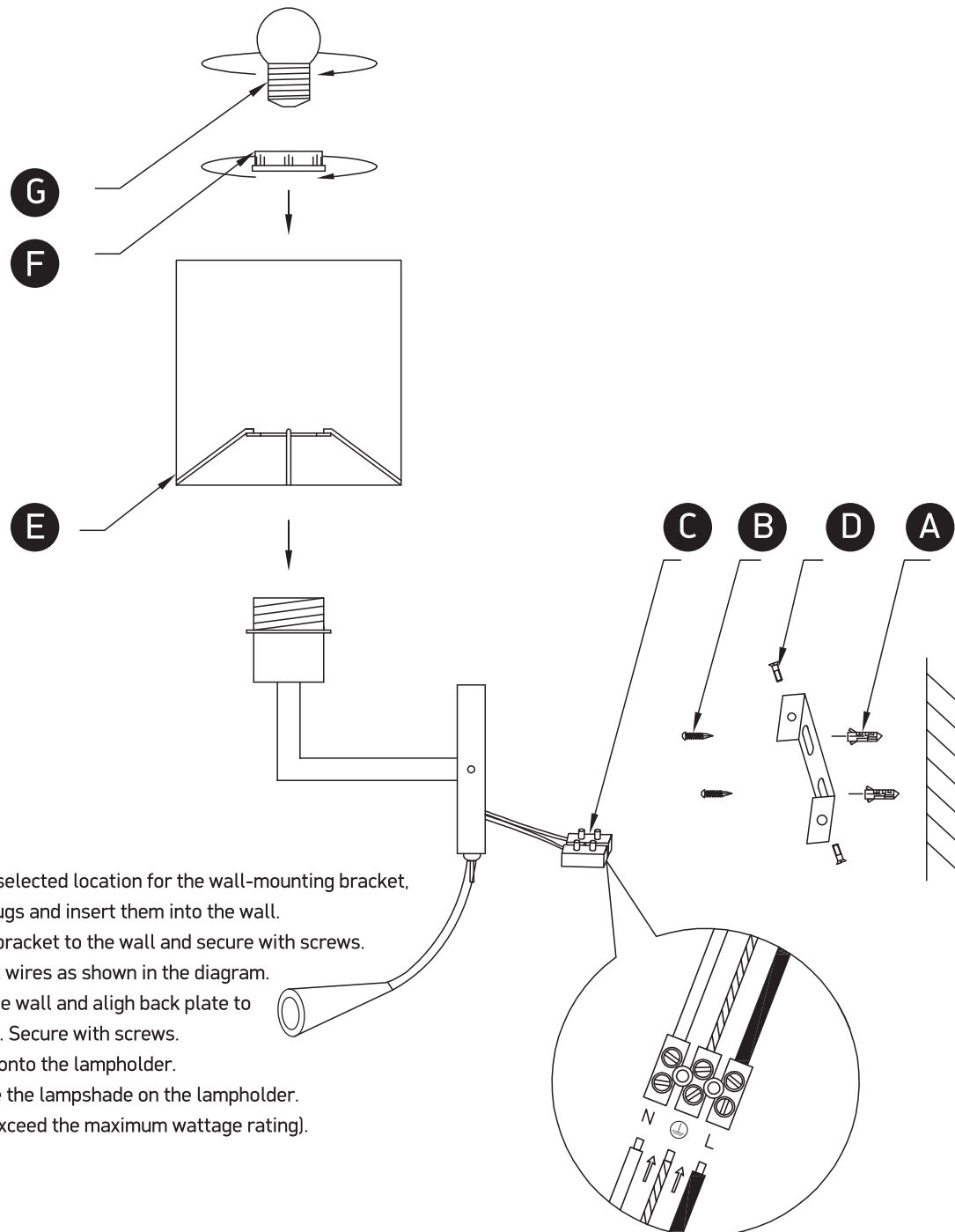

- Mark on the wall the selected location for the wall-mounting bracket, drill holes for wall plugs and insert them into the wall.
- Attach the mounting bracket to the wall and secure with screws.
- Connect the electrical wires as shown in the diagram.
- Place the fixture to the wall and align back plate to the mounting bracket. Secure with screws.
- Place the lampshade onto the lampholder.
- Use the ring to secure the lampshade on the lampholder.
- Install lamp (Do not exceed the maximum wattage rating).

Warnings:

- Make sure that the product is installed properly before connecting to electricity.
- Do not cover the fitting.
- Maintenance and installation should only be carried out by a professional electrician.