

INSTALLATION MANUAL

10122FD

ecodownlight

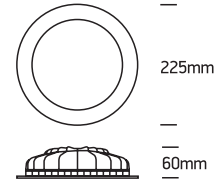

230V | SMD 2835 | 22W | IP20 | Die cast
Complete with 600mA driver.

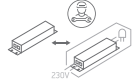

80 CRI

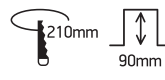

one
LIGHT

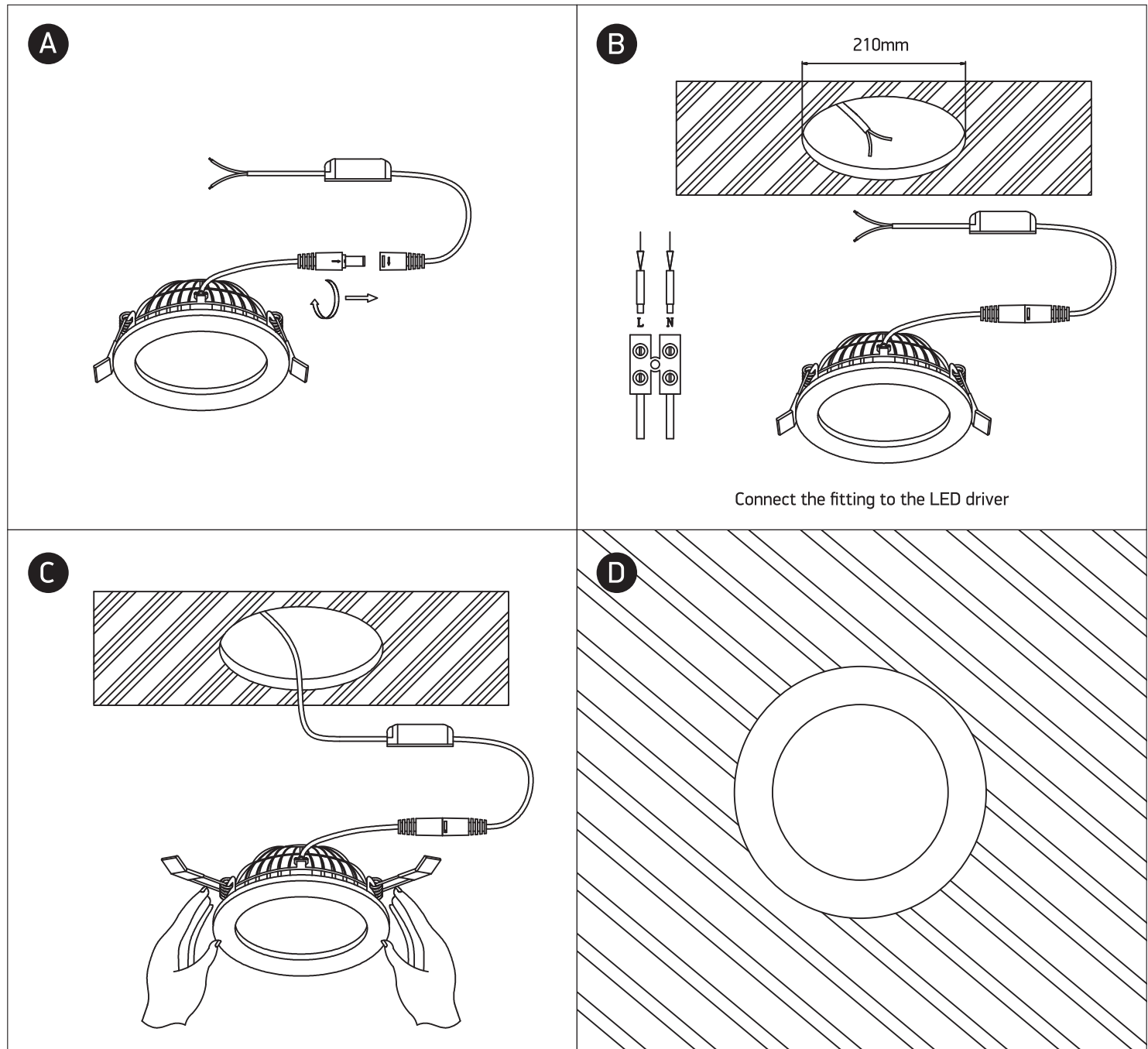

Warnings:

1. Make sure that the product is installed properly before connecting to electricity.
2. Do not cover the fitting.
3. Maintenance and installation should only be carried out by a professional electrician.