

# LUCIDE

## GENERAL SPECIFICATIONS



### RECOMMENDED LUCIDE LIGHT SOURCE

**49034/05/62**

Light source dimmable : Yes

Light source incl. : No

### General

**Dimensions LxWxH :** 12.0 cm x 12.0cm x 80.0 cm

**Height minimum :** 80.0 cm

**Height maximum :** 80.0cm

**Dimensions shade LxWxH :**

**Main material :** Aluminum

**Ceiling rose material :**

**Color :** Black

**Style :** Modern

**Shape :** Cylinder

**Weight :** 2.10kgs

**Warranty :** 2 years

### Product specifications

**Dimmable :** No

**Light direction :** Around (Diffuse)

**Adjustable in height :** No

**Directional :** Not Directional

**Cable :** No

**Cable length :**

**Sensor :** With day/night sensor

**Control :** Light Switch Control

**IP-Class :** 44

**Electric class :** 1

**Light source including ? :** No

**Lamp socket :** E27

**Light source number :** 1

**Power requirements :** 220-240V-50Hz

**Bulb type & maximum wattage :** E27 Max 15W

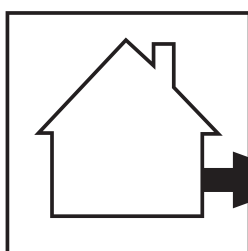

IP44

IP54

IP65

IP67

Explanation of IP numbers for degrees of protection, see safety instruction manual in the box.

For more specifications of this product please visit

**[www.lucide.com](http://www.lucide.com)**

LUCIDE

TECHNICAL DRAWING & DIMENSIONS

# LORI

Item number : 14893/80/30

EAN code : 5411212144317

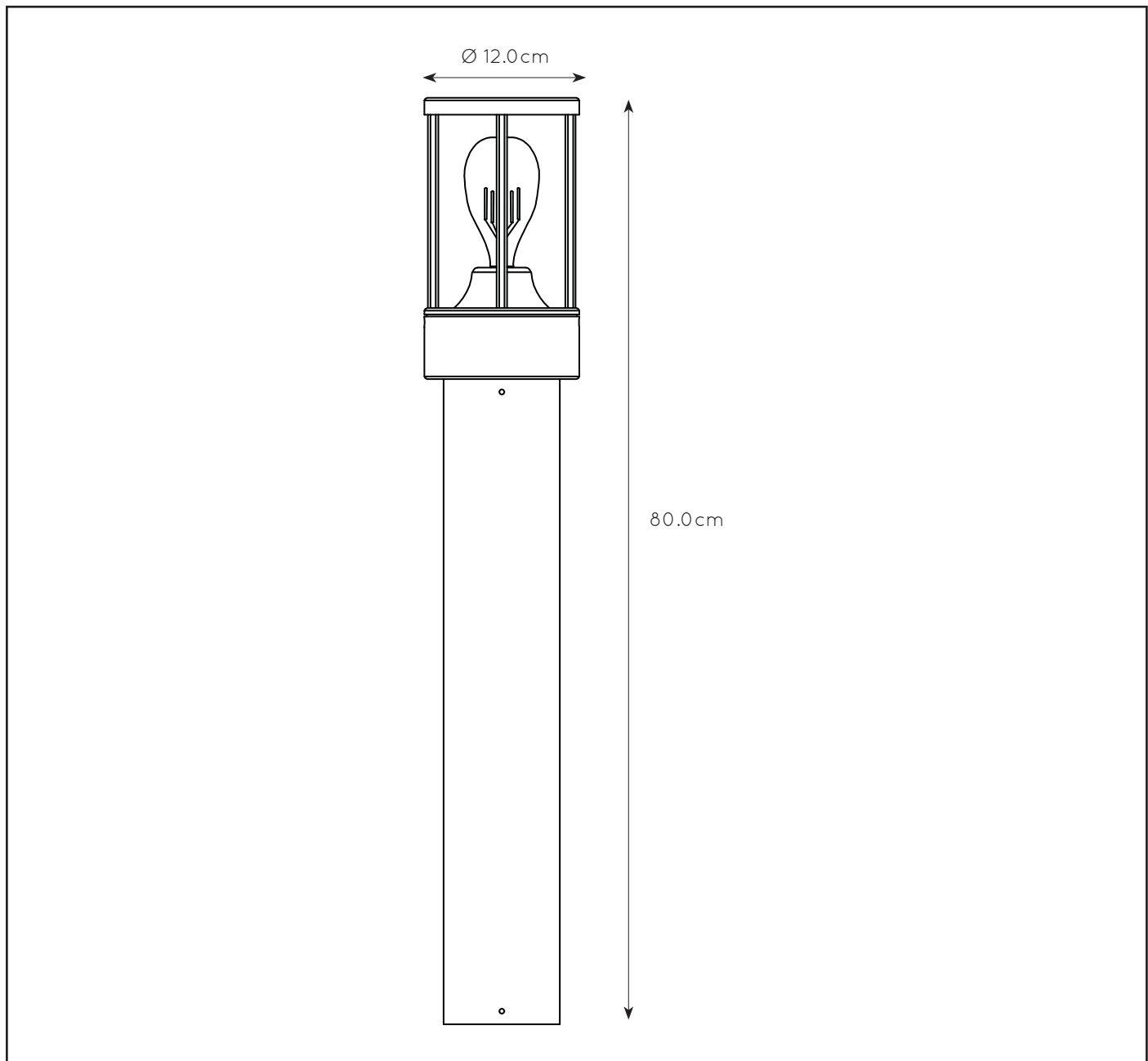

For more specifications, dimensions please visit

[www.lucide.com](http://www.lucide.com)

# LUCIDE

## INSTALLATION DRAWING SPECIFICATIONS

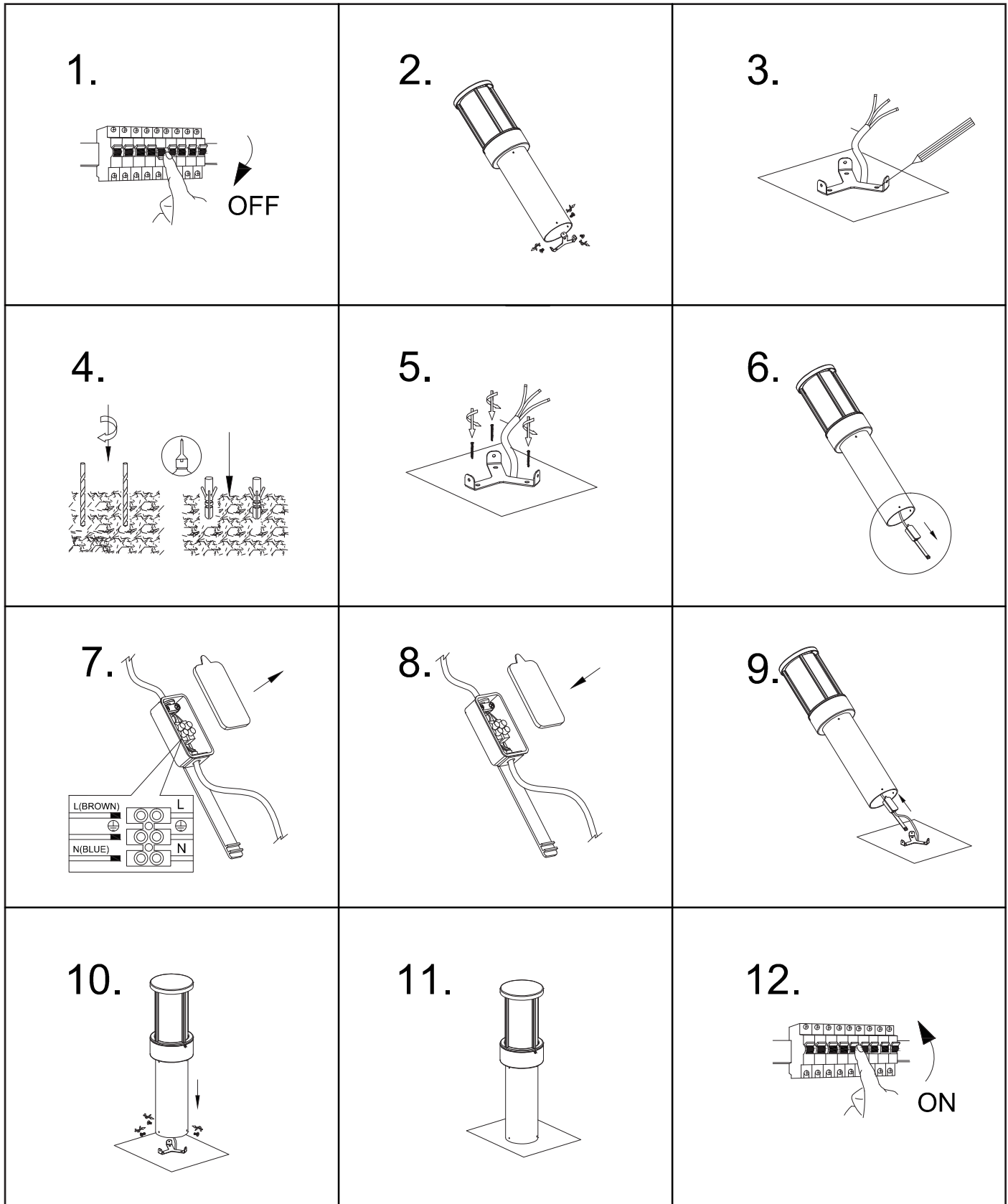

L U C I D E

## INSTALLATION DRAWING SPECIFICATIONS

## Control Sensor Technique Index &amp; Directions

## Main technique index

- 1) Light control: Open-controlled:  $\leq 25\text{LUX}$ , Off-controlled:  $30\text{-}60\text{LUX}$
- 2) Frequency:  $50\text{-}60\text{Hz}$
- 3) Lighting Control Power:  $100\text{W}$
- 4) Voltage:  $220\text{-}240\text{VAC}$
- 5) Consume power:  $\leq 1.0\text{W}$

## I. How to circuit Illustration:

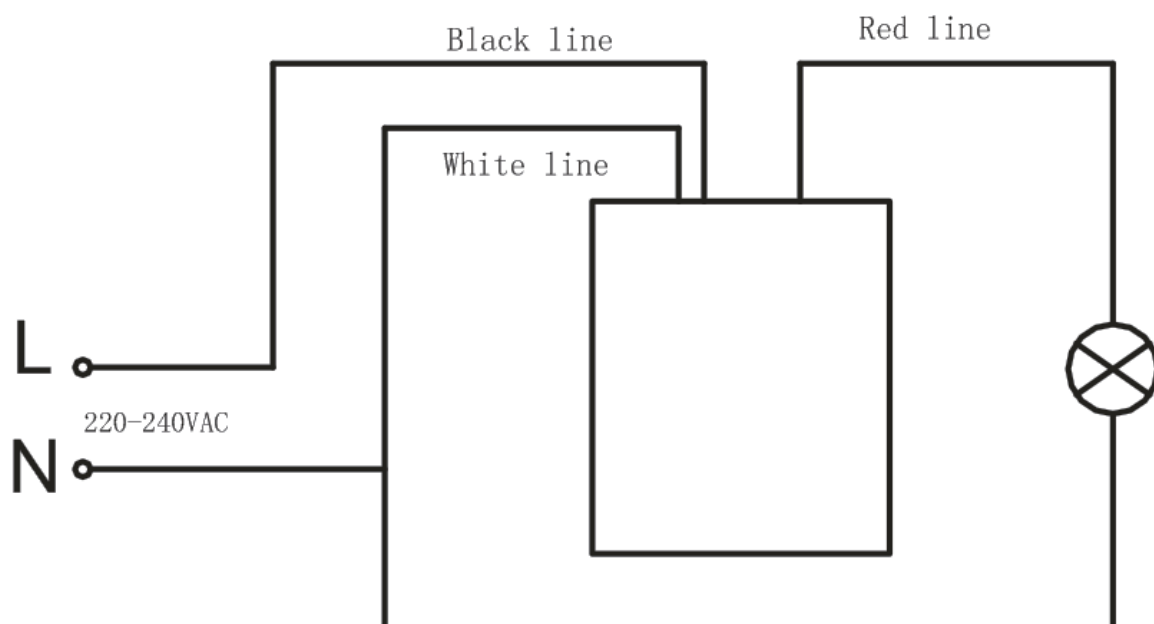

II. Caution Please avoid installing the controller in the open air.